

### DIRECTIONS

#### PLEASE READ TO ENSURE PROPER INSTALLATION

**WARNING:** Never ride with loose or torn grips. Check all areas of your motorcycle before riding for safety. Ensure the motorcycle is safe and well maintained before riding. Motorcycles and the sport of motocross can be dangerous. Ride at your own risk.

**WARNING:** The spray catalyst is an activant. Do not spray in your eyes or mouth. If catalyst gets in your eyes, simply wash out thoroughly with water.

For more instruction please see an installation demo video on our web site.  
[www.riskracing.com](http://www.riskracing.com)

#### STEP 1

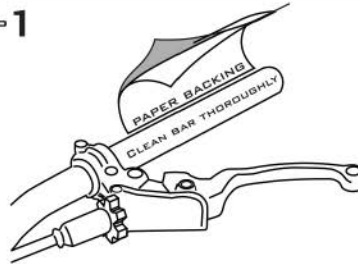

- Thoroughly clean the bar.
- Peel off one side of paper backing and apply the sticky surface of the bonding strip to the bar with about a 1/16th inch overhang over the end of the bar.
- Don't be concerned if bonding strips don't seem overly sticky yet.

**Continued..→**

#### STEP 2

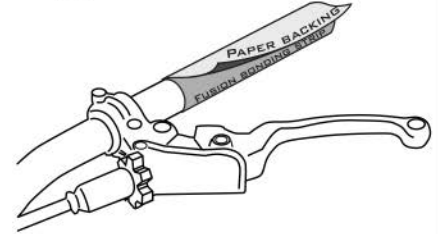

- After the bonding strip is applied to the bar, remove the remaining paper backing which will expose the bonding surface.
- Next, shake the catalyst bottle thoroughly. The catalyst is an activant and it is necessary for proper bonding.

#### STEP 3

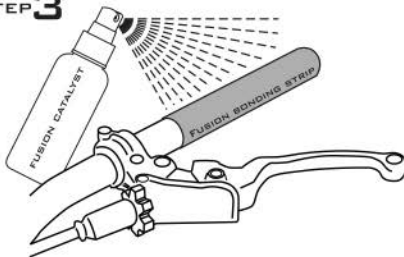

- Spray the exposed bonding strips with catalyst (3-4 squirts).
- Use your hand to ensure all areas of bonding strips get wet.
- Spray 2-3 squirts into the grip. Place thumb over grip end and shake. Shake excess catalyst out of grip.
- Apply grips before catalyst dries.

#### STEP 4

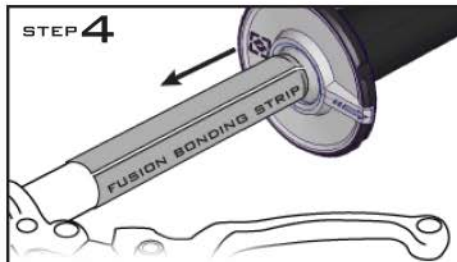

- Slide correct size grip over the bonding strip (grip with larger inner diameter is for the throttle side).
- **Make sure the bonding strip does not peel up under the grip when the grip is applied.** (The 1/16th inch overhang helps prevent this).
- The grip should slide on with ease. If it is hard to apply, take off the grip and apply more catalyst.

#### STEP 5

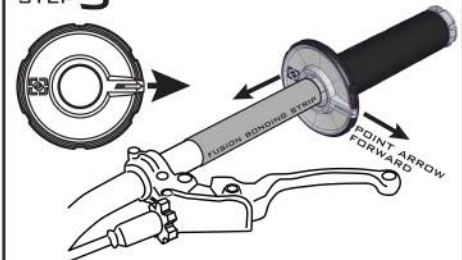

- **Position the arrow on the grip horizontal and point it toward front of bike.**
- Make sure there is no air trapped between the grip and the bar. When positioned correctly and all air is removed, allow time to dry. Dry time will vary according to amount of catalyst. Minimum 1 hour.