

INSTRUCTIONS

ATTENTION:

READ ALL INSTRUCTIONS BEFORE USE!

The RIPPER mounts to most goggle roll-off systems. *For best results, use a quality roll-off system from a quality manufacturer.*

The roll-off system must be in good operating condition. The pull cord **MUST** be smooth and easy to pull.

MOST ISSUES ARE CAUSED BY FAULTY OR CLOGGED ROLL-OFF SYSTEMS. READ TROUBLESHOOTING GUIDE IF YOU HAVE ANY ISSUES.

STEP 1: CHARGE YOUR UNIT BEFORE FIRST USE!

USB CHARGING:

Plug an standard Micro USB plug with charger into The RIPPER. Charge time depends on the charge capacity of the charger used. When charging is complete, be sure to fully close the USB rubber plug before use to prevent contamination and failure.

PATENTS PENDING
ITEM#: 00395

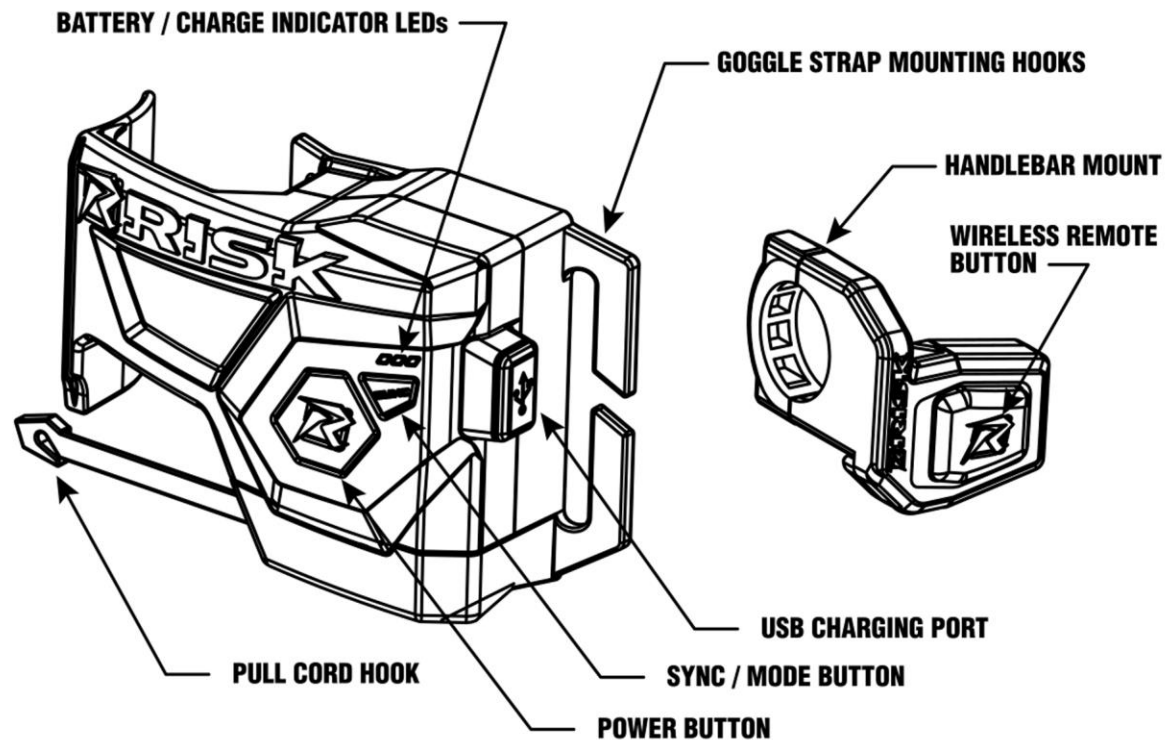

TRY THE RIPPER WITH RISK RACING

J.A.C. GOGGLES

MOUNT THE RIPPER ON THE GOGGLE:

STEP 1: Thread the goggle strap through the goggle strap mounting hooks.

STEP 2: Slide the Ripper up against the side of the roll-off canister.

STEP 3: Extend the pull cord away from the roll-off system and hook the "Pull Cord Hook" on the string of the pull cord.

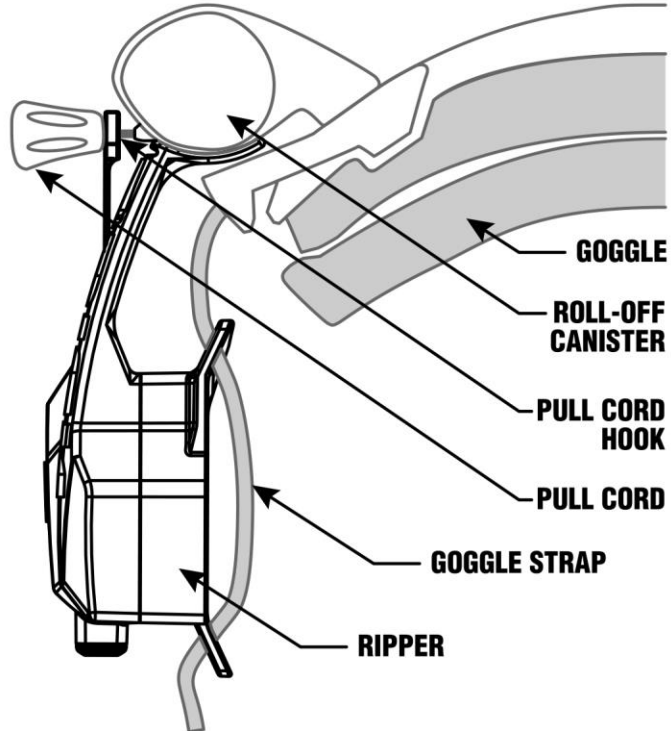

MOUNT THE WIRELESS REMOTE ON HANDLEBARS:

Mount the wireless remote on the left side of the handlebars. You may have to move some components around to make room for the remote button.

Note: Place the button closest to the grip, but leave room for the grip flange to flex inward. *If your grip flange can't flex inward it can cause blisters to your thumb. SEE FIGURE 1.*



POWER ON / OFF:

POWER ON: Press the power button to turn the unit on. The battery indicator LEDs will illuminate showing the unit has power.

POWER OFF: Press & hold the power button for 1 second, and release. The battery indicator LEDs will turn off after the button is released.

SYNC FUNCTION:

The RIPPER can be synced to multiple buttons so you can have a unique button on multiple bikes if necessary (Extra buttons sold separately).

It may be necessary to sync the button to The Ripper when new. If the wireless remote button does not activate The RIPPER, try syncing the button.

To sync the wireless remote button to The Ripper, press & hold the "SYNC / MODE Button" for 1 second. The battery indicator LED's will flash. Press the wireless remote button that you would like to sync to The Ripper. The battery indicators LEDs will flash and then go solid. Your remote is now synced.

NOTE: Only ONE remote can be synced to The RIPPER at a time. If you have multiple bikes with wireless buttons, you will need to re-sync The RIPPER as you change bikes.

MODE FUNCTION:

The RIPPER has two different modes. The modes affect how long The RIPPER operates per press of the remote button. The exact amount of film pulled varies depending on two variables: 1. The model roll-off system. 2. The diameter of the "feed roll" (new side of the roll film) and the "take-up roll" (Used side of the roll

film). As a roll of film is used, the feed roll diameter decreases and the take-up roll diameter increases. As the take-up roll diameter increases, the Amount of film pulled across the users eyes increases with every pull. This variable is different for every model of roll-off system. Use the two available modes to preselect how you would like The RIPPER to use the film available.

SWITCHING MODES: A quick press of the **MODE / SYNC** button will changes between Mode 1 and Mode 2. *Note: if you press too long it will go into SYNC mode. Just re-sync your button and try the mode button again.*

MODE 1: When the remote button is pressed, The Ripper runs for approximately 1 full second. This is the default mode and the simplest. In this mode The Ripper may require one or two presses to fully clear the riders vision at the very beginning of a new roll, but should clear the vision on any roll-off system with one press after the take-up roll gains some diameter.

MODE 2: This changes the wireless button into “Momentary Switch” mode, meaning that The RIPPER will activate for only as long as the button is pressed. This mode lets the user more accurately control the use of film as the roll diameters change.

Mode 1 requires less user thought and input, but both modes are more efficient with roll film than the traditional method of pulling the cord manually several times while at race pace.

MANUAL FUNCTION:

The RIPPER is designed to allow the user to still reach up and grab the pull cord and manually pull to advance the film. This is a safeguard if there is ever a situation where The RIPPER is not able to advance the film.

If The RIPPER is not able to advance the film, the issue is typically not directly related to mud, but more related to the proper function of the roll-off system you are using. For more on this see the troubleshooting section.

BATTERY / CHARGE INDICATOR LEDS:

CHARGING: The LEDs will cycle when charging. They will stay solid when fully charged.

The three LEDs indicate battery power status. One LED = 0%-33% charge, 2 LEDs = 34%-66% charge, 3 LEDs = 67% -100% charge

USB CHARGING:

Plug a standard Micro USB plug with charger into The RIPPER. Charge time depends on the charge capacity of the charger used.

When charging is complete, be sure to fully close the USB rubber plug before use to prevent contamination and failure.

WIRELESS REMOTE BATTERY: (Type = CR2032)

The Wireless remote comes with a battery installed. It should last a long time, but in the event that your signal strength goes weak, try replacing your remote battery. Simply unscrew the back of the wireless remote button and replace the existing battery with a new one. Battery model = CR2032.

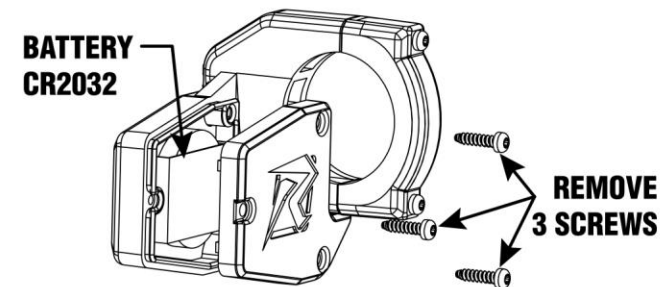

SEE BACK PAGE FOR TROUBLESHOOTING



TROUBLESHOOTING:

NOT ENOUGH FORCE TO PULL THE STRING:

1. Make sure The RIPPER is fully charged.
2. The most common reason is due to the fact that the Roll-Off system is worn out, the gear system is clogged up, or the “friction braking system” on the roll film axle is out of spec causing a high pull force on the pull string.

If The RIPPER is unable to pull the pull string, test the pull force by pulling the string with your hand. If the pull is not smooth and fluid, as a properly functioning roll-off system should be, then look to maintaining your roll-off system.

Clean all areas of the roll-off system. If the issue is the friction on the roll film axle, try cleaning and placing a little grease on the ends of the film axles to make it pull smoother.

NO SIGNAL:

1. Make sure The RIPPER is fully charged.
2. Try re-syncing your wireless remote button. (Wireless range is limited to approx 3 feet max.)
3. Replace battery in wireless remote button.

GRINDING SOUND AND NO PULL:

1. Remove the gear cover and check health of gear system. These are wear parts. Replacement parts are available.

REPLACEMENT PARTS:

The Pull Cord Hook & Gear Assembly, and the Motor Drive Gear are “wear” parts. Depending on use, both items may suffer from general wear & tear. Both items are replaceable in the event of damage or wear & tear. They are available for purchase at www.riskracing.com. See below for basic replacement schematic.

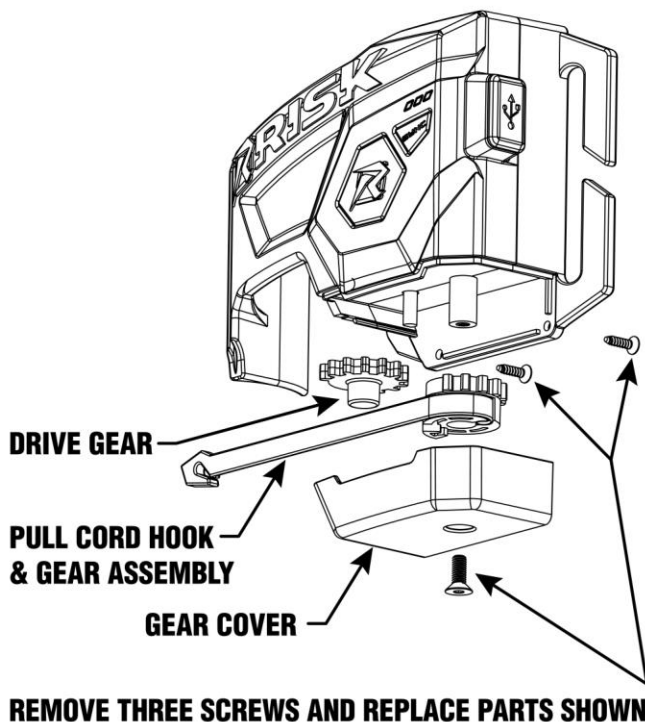

RISK



15% COUPON CODE: MOTO 15

*Limited time coupon

RISK RACING

116 BURRY CT
TROUTMAN, NC 28166
704-508-1031
INFO@RISKRACING.COM

www.RISKRACING.com